

vtech[®]
Baby

User's Manual

Turn & Learn Cube



© 2014 VTech
Printed in China
91-002888-001 

VTech understands that a child's needs and abilities change as they grow and with that in mind we develop our toys to teach and entertain at just the right level...

Electronic Learning Computers

Cool, aspirational and inspiring computers for curriculum related learning

vtech Baby

Toys that will stimulate their interest in different textures, sounds and colours

I am...

...responding to colours, sounds and textures

...understanding cause and effect

...learning to touch, reach, grasp, sit-up, crawl and toddle

Pre-School

Interactive toys to develop their imagination and encourage language development

I want...

...to get ready for school by starting to learn the alphabet and counting

...my learning to be as fun, easy and exciting as can be

...to show my creativity with drawing and music so my whole brain develops

I need...

...challenging activities that can keep pace with my growing mind

...intelligent technology that adapts to my level of learning

...National Curriculum based content to support what I'm learning at school

Birth-36 months



3-6 years



4-10 years



To learn more about this and other VTech® products, visit www.vtechuk.com

INTRODUCTION

Thank you for purchasing the **VTech® Turn & Learn Cube** learning toy! Learn and play every day with the **Turn & Learn Cube** by **VTech®**! Featuring 5 sides to explore, this activity cube attracts your baby's attention with music, light-up buttons, colours and more. They'll develop their motor skills and have fun with so many activities all in one!

4 LIGHT-UP SHAPE BUTTONS

ON/OFF/VOLUME CONTROL SWITCH



SPINNING LETTER BLOCKS

3 INSTRUMENT BUTTONS

INCLUDED IN THIS PACKAGE

- One VTech® Turn & Learn Cube
- One instruction manual

WARNING: All packing materials, such as tape, plastic sheets, packaging locks and tags are not part of this toy, and should be discarded for your child's safety.

NOTE: Please keep this instruction manual as it contains important information.

GETTING STARTED

BATTERY INSTALLATION

1. Make sure the unit is turned **OFF**.
2. Locate the battery cover on the back of the unit. Use a coin or a screwdriver to loosen the screw.
3. Install 2 new 'AAA' (LR03/AM-4) batteries following the diagram inside the battery box. (The use of new alkaline batteries is recommended for maximum performance.)
4. Replace the battery cover and tighten the screw to secure.

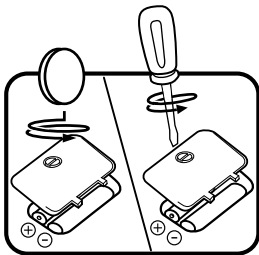

BATTERY NOTICE

- Use new alkaline batteries for maximum performance.
- Use only batteries of the same or equivalent type as recommended.
- Do not mix different types of batteries: alkaline, standard (carbon-zinc) or rechargeable (Ni-Cd, Ni-MH), or new and used batteries.
- Do not use damaged batteries.
- Insert batteries with the correct polarity.
- Do not short-circuit the battery terminals.
- Remove exhausted batteries from the toy.
- Remove batteries during long periods of non-use.
- Do not dispose of batteries in fire.
- Do not charge non-rechargeable batteries.
- Remove rechargeable batteries from the toy before charging (if removable).
- Rechargeable batteries are only to be charged under adult supervision.

Disposal of batteries and product



The crossed-out wheellie bin symbols on products and batteries, or on their respective packaging, indicates they must not be disposed of in domestic waste as they contain substances that can be damaging to the environment and human health.



The chemical symbols Hg, Cd or Pb, where marked, indicate that the battery contains more than the specified value of mercury (Hg), cadmium (Cd) or lead (Pb) set out in Battery Directive (2006/66/EC).

The solid bar indicates that the product was placed on the market after 13th August, 2005.

Help protect the environment by disposing of your product or batteries responsibly.

For more information, please visit:

www.recycle-more.co.uk

www.recyclenow.com

PRODUCT FEATURES

1. ON/OFF/VOLUME CONTROL SWITCH

To turn the unit **ON**, slide the **ON/OFF/VOLUME CONTROL SWITCH** to the **LOW VOLUME** (🔊) or the **HIGH VOLUME** (🔊) position. To turn the unit **OFF**, slide the **ON/OFF/VOLUME CONTROL SWITCH** to the **OFF** (●) position.

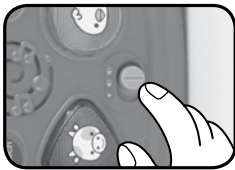

2. AUTOMATIC SHUT OFF

To preserve battery life, the **VTech® Turn & Learn Cube** will automatically power-down after approximately 60 seconds without input. The unit can be turned on again by pressing any button.

ACTIVITIES

1. Slide the **ON/OFF/Volume control switch** to turn the unit on. You will hear a playful sound, a fun sing-along song and a phrase. The lights will flash with the sounds.

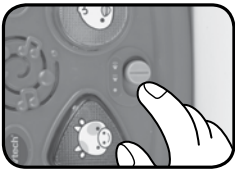

2. Press the **Light-Up Shape Buttons** to learn animal names, animal sounds, shapes and hear playful sing-along songs and music. The lights will flash with the sounds.

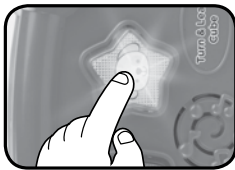

3. Press, slide or twist the **instruments** to learn colours, instrument names, instrument sounds and hear a variety of melodies. The lights will flash with the sounds.

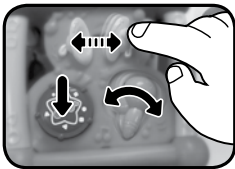

4. Shake the cube to activate the motion sensor and hear a variety of fun sounds. The lights will flash with the sounds.

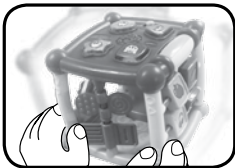

MELODY LIST

1. Three Little Kittens
2. Alouette
3. Old MacDonald Had a Farm
4. Bingo
5. Hey Diddle Diddle
6. This Old Man
7. Alphabet Song
8. Humpty Dumpty
9. Pease Porridge Hot
10. Row, Row, Row Your Boat
11. Three Blind Mice

12. Sing a Song of Sixpence
13. Polly Put the Kettle On
14. Grandfather's Clock
15. Bear Went Over the Mountain
16. While Strolling Through the Park One Day
17. Turkey in the Straw
18. Big Rock Candy Mountain
19. Yankee Doodle
20. Take Me Out To The Ballgame

SING-ALONG SONG LYRICS

Sing-Along Song 1

Come and say, "Hi."
There's fun on 5 sides.
Meet the animals, beat the drum.
The cube is fun for everyone!

Sing-Along Song 2

The cat in the square,
Is peeking out of there.
Meow, meow, meow, meow.
The cat's in the square.

Sing-Along Song 3

The bird in the circle,
Sings a song that's wonderful.
Tweet, tweet, tweet, tweet.
The bird's in the circle.

Sing-Along Song 4

The cow in the triangle,
Wants to sing for you.
Moo, moo, moo, moo.
The cow's in the triangle.

Sing-Along Song 5

The dog in the star,
Barks and runs far.
Woof, woof, woof, woof.
The dog's in the star.

CARE & MAINTENANCE

1. Keep the unit clean by wiping it with a slightly damp cloth.
2. Keep the unit out of direct sunlight and away from any direct heat source.
3. Remove the batteries when the unit will not be in use for an extended period of time.
4. Do not drop the unit on hard surfaces and do not expose the unit to moisture or water.
5. If the product still does not work, replace with an entire set of new batteries.

TROUBLESHOOTING

If for some reason the program/activity stops working or malfunctions, please follow these steps:

1. Please turn the unit **OFF**.
2. Interrupt the power supply by removing the batteries.
3. Let the unit stand for a few minutes, then replace the batteries.
4. Turn the unit **ON**. The unit should now be ready to play again.
5. If the product still does not work, replace with an entire set of new batteries.

If the problem persists, please call our Consumer Services Department on 01235 546810 (from UK) or +44 1235 546810 (outside UK) and a service representative will be happy to help you.

IMPORTANT NOTE:

Creating and developing **VTech®** products is accompanied by a responsibility that we take very seriously. We make every effort to ensure the accuracy of the information, which forms the value of our products. However, errors sometimes can occur. It is important for you to know that we stand behind our products and encourage you to call our Consumer Services Department on 01235 546810 (from UK) or +44 1235 546 810 (outside UK), with any problems and/or suggestions that you might have. A service representative will be happy to help you.

**CLASS 1
LED PRODUCT**



vtech®

PRODUCT WARRANTY



Thank you for choosing this quality product from VTech. We hope it will bring many hours of entertainment, imaginative play and learning.

1. The product detailed above is covered by a one year warranty from the date of purchase, against any defects in materials or workmanship.
2. The product may be returned to the place of purchase. Alternatively the product can be returned to VTech Electronics Europe plc (see address below), with proof of purchase, without proof of purchase no replacement will be provided.
3. VTech Electronics Europe plc will examine the product and if it is found to be defective due to faulty materials or workmanship, will replace the product at their discretion.
4. If the product covered by this warranty is damaged due to misuse, modification or unauthorised repair, or because of faulty batteries, battery discharge or incorrect electrical connections, then this warranty becomes void.
5. This warranty is personal to the original purchaser and is not transferable.
6. Breakages to the LCD screen are not covered by the warranty.
7. Returns to VTech Electronics Europe plc should include a cheque or postal order for £1.50 towards the cost of return postage and packaging.
8. Products returned to VTech Electronics Europe plc, should be addressed as follows and packed carefully to avoid damage in transit (Please do not include batteries or adaptor).
Please include details of the fault together with your name and address.

VTech Electronics Europe plc, c/o Tablogix Limited, 200 Milton Park, Abingdon, Oxon OX14 4TA

THIS WARRANTY IS OFFERED AS AN EXTRA BENEFIT AND DOES NOT AFFECT CONSUMERS' STATUTORY RIGHTS.

This warranty is valid for the UK and Eire only. For products purchased outside the UK and Eire, please contact your local distributor or place of purchase.